



UNIVERSITY  
*of* VIRGINIA

**Board of Visitors Buildings & Grounds Committee**  
**December 11, 2020**

# Agenda

---

- Remarks by the Chair
- Schematic Design Approvals:
  - Smith Hall Renovation
  - Observatory Water Treatment Plant
  - School of Data Science
- Schematic Design Review: Athletics Complex

# Consent Agenda: Schematic Design Approvals

---

## *Smith Hall Renovation*



*Rendering from the Arboretum looking west towards Smith Hall*

## *Observatory Water Treatment Plant*



*Proposed view facing north*

# Schematic Design Approval: School of Data Science

---





JPJ

NORTH GROUND ATHLETIC

HOTEL

EMMET/IVY GARAGE

SDS

IRC

LAMBETH FIELD RESIDENTIAL

EMMET STREET SMARTSCALE

EMMET IVY CORRIDOR – INITIAL BUILDINGS

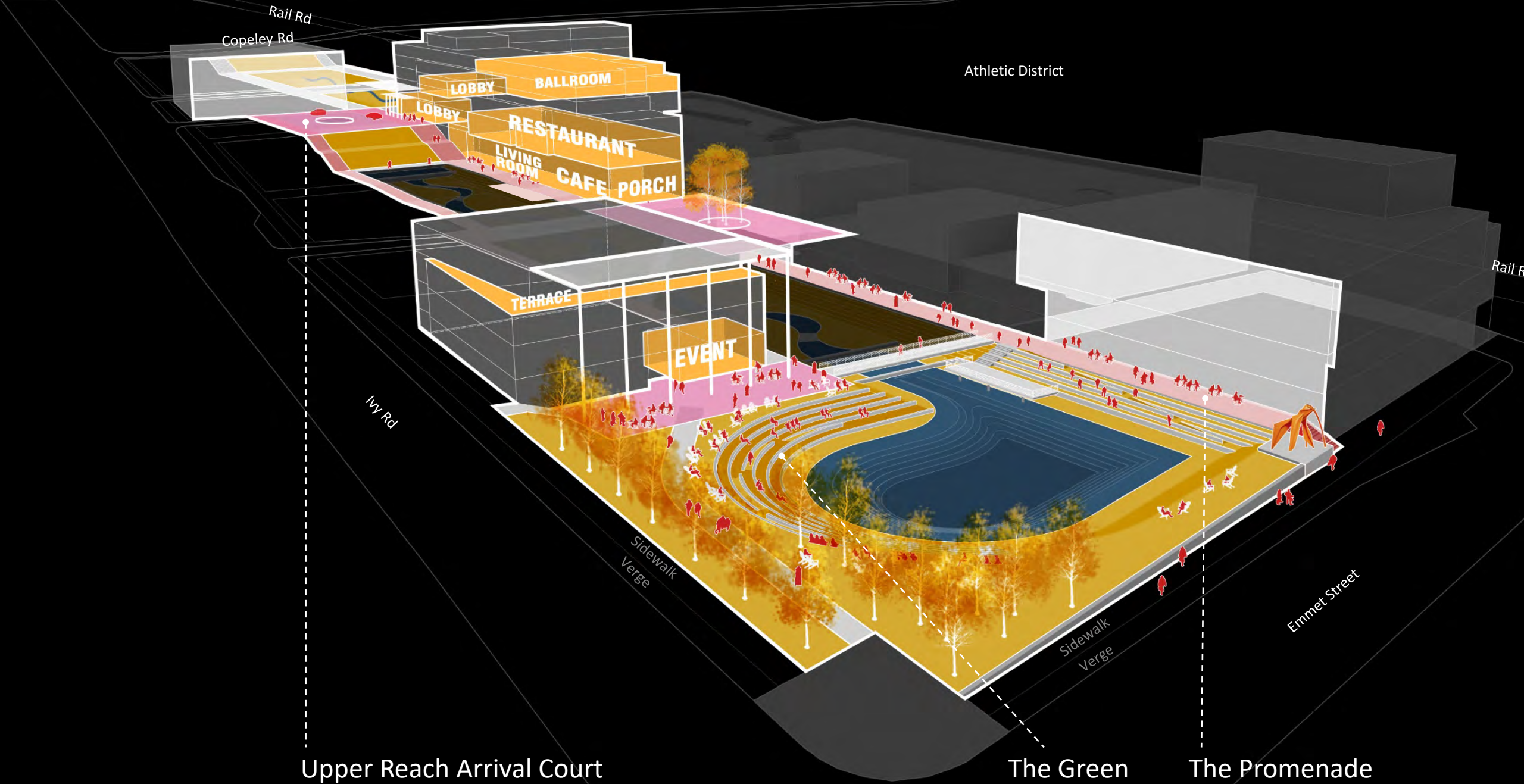

**PUBLIC SPACE CONNECTIONS**

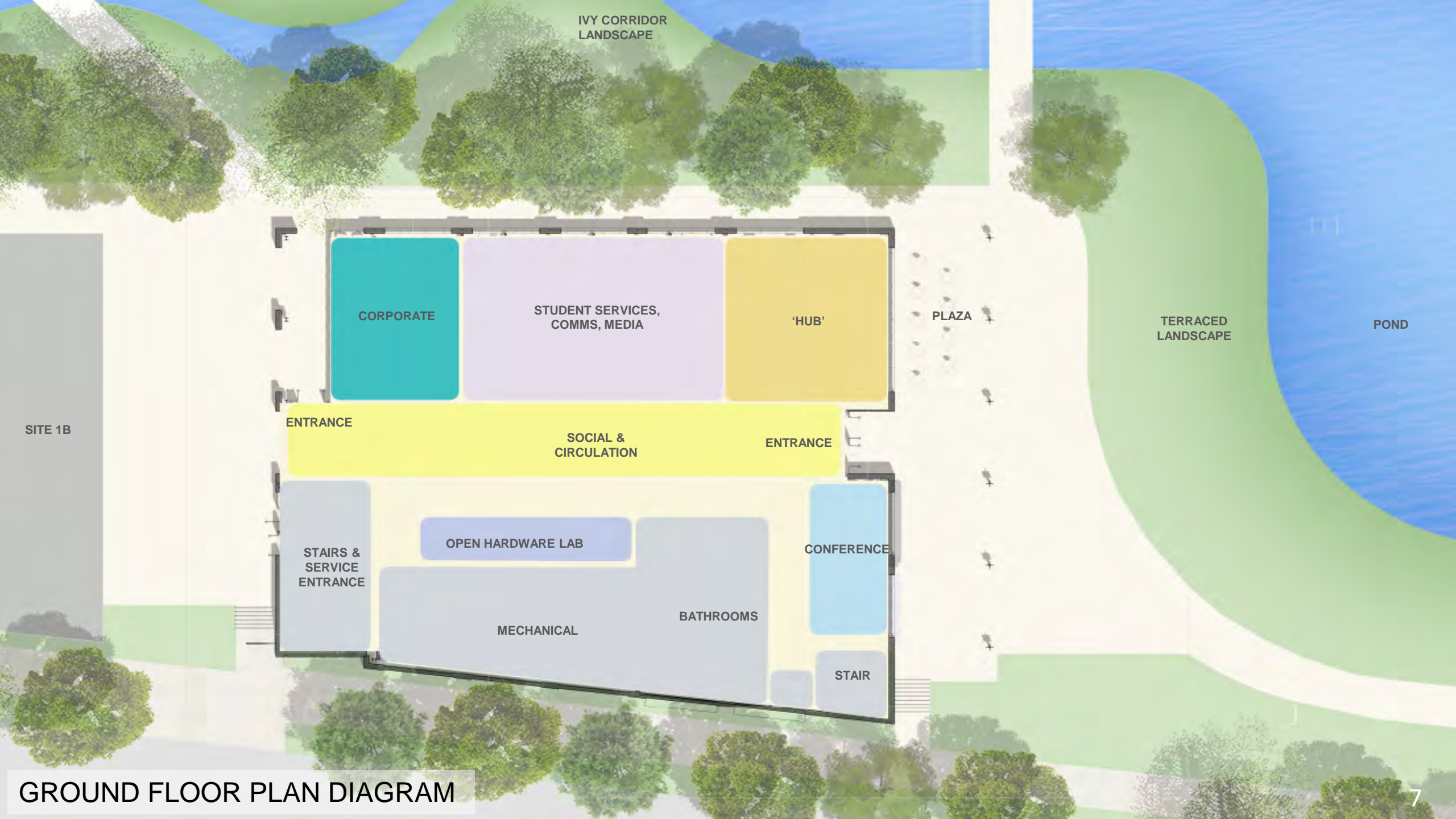

GROUND FLOOR PLAN DIAGRAM



PROPOSED VIEW OF THE HUB AND GALLERY, LOOKING NORTH





PROPOSED VIEW OF CENTRAL STAIR, LOOKING EAST



PROPOSED AERIAL VIEW LOOKING WEST

Roof mounted HVAC for efficient heating / cooling; Dedicated Outdoor Air System



PV-ready roof structure



Improved comfort to building and plaza from Portico solar shading

Openable windows naturally ventilate



Green Roof



Brise-soleil control overheating



Trees provide solar shading in summer



Advanced Data Utilization (add alt)



High performance facade



Stream & Planting enhances microclimate and biodiversity



District-wide stormwater retention





PROPOSED VIEW FROM IVY ROAD LOOKING NORTHWEST



PROPOSED TERRACE VIEW LOOKING SOUTH EAST



PROPOSED VIEW FROM THE PROMENADE LOOKING SOUTHEAST



North Elevation Detail



**Eaves detail**  
White metal channel



**Brise-Soleil**  
Light grey metal louvres



**Metal panel**  
White metal opening panels



**Windows**  
Light grey frames

**Brickwork**  
Stretcher bond

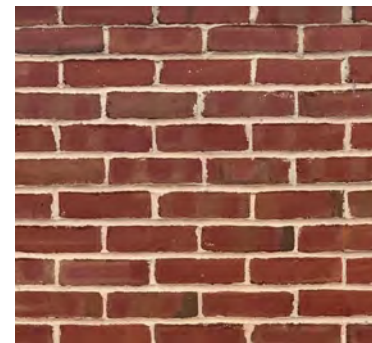

Flemish bond

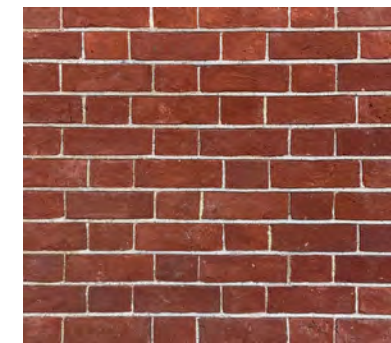



PROPOSED VIEW FROM THE PROMENADE LOOKING SOUTHWEST





PROPOSED DUSK VIEW FROM THE PROMENADE LOOKING SOUTHWEST

# Schematic Design Review: Athletics Complex

---



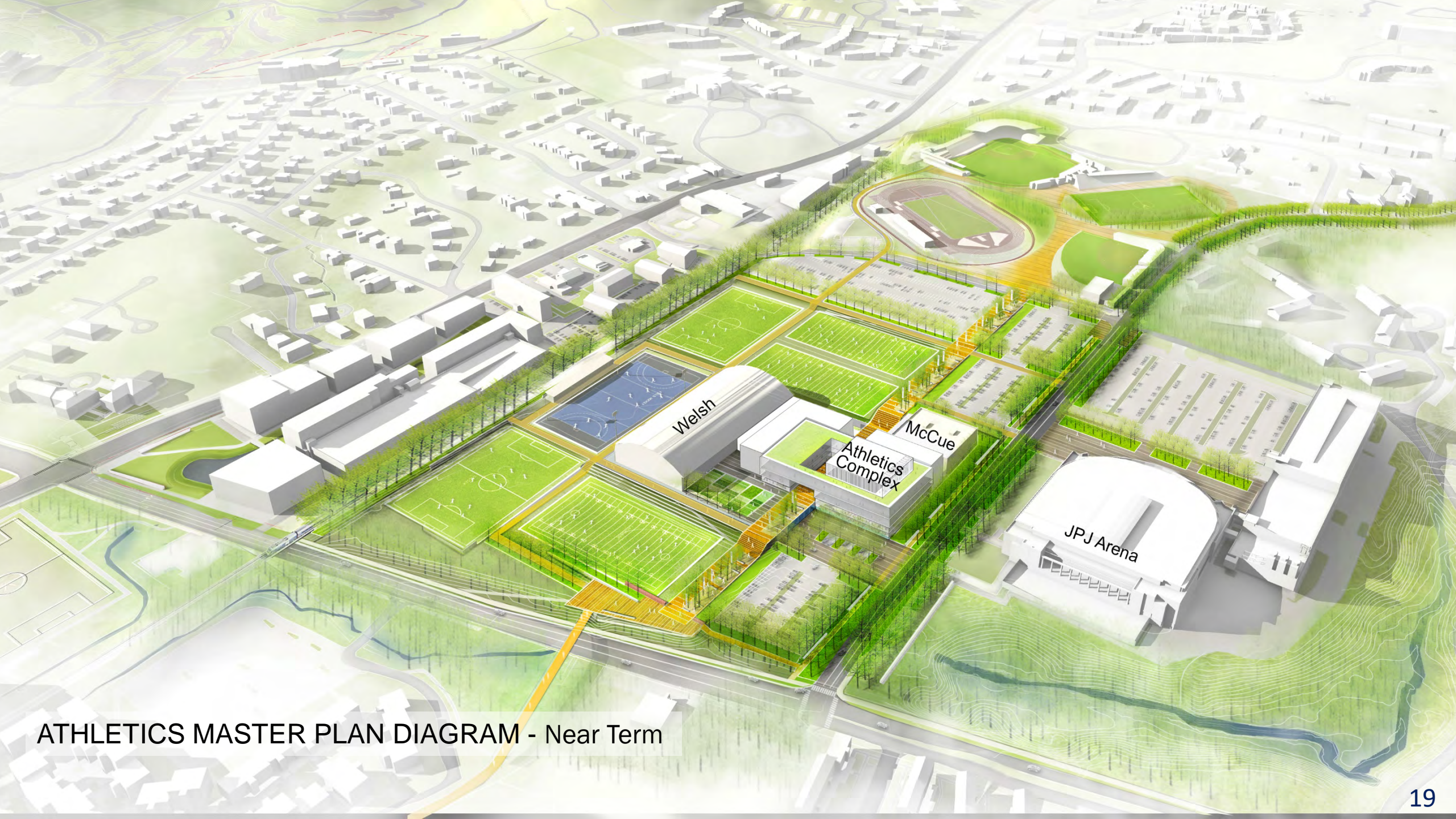

ATHLETICS MASTER PLAN DIAGRAM - Near Term

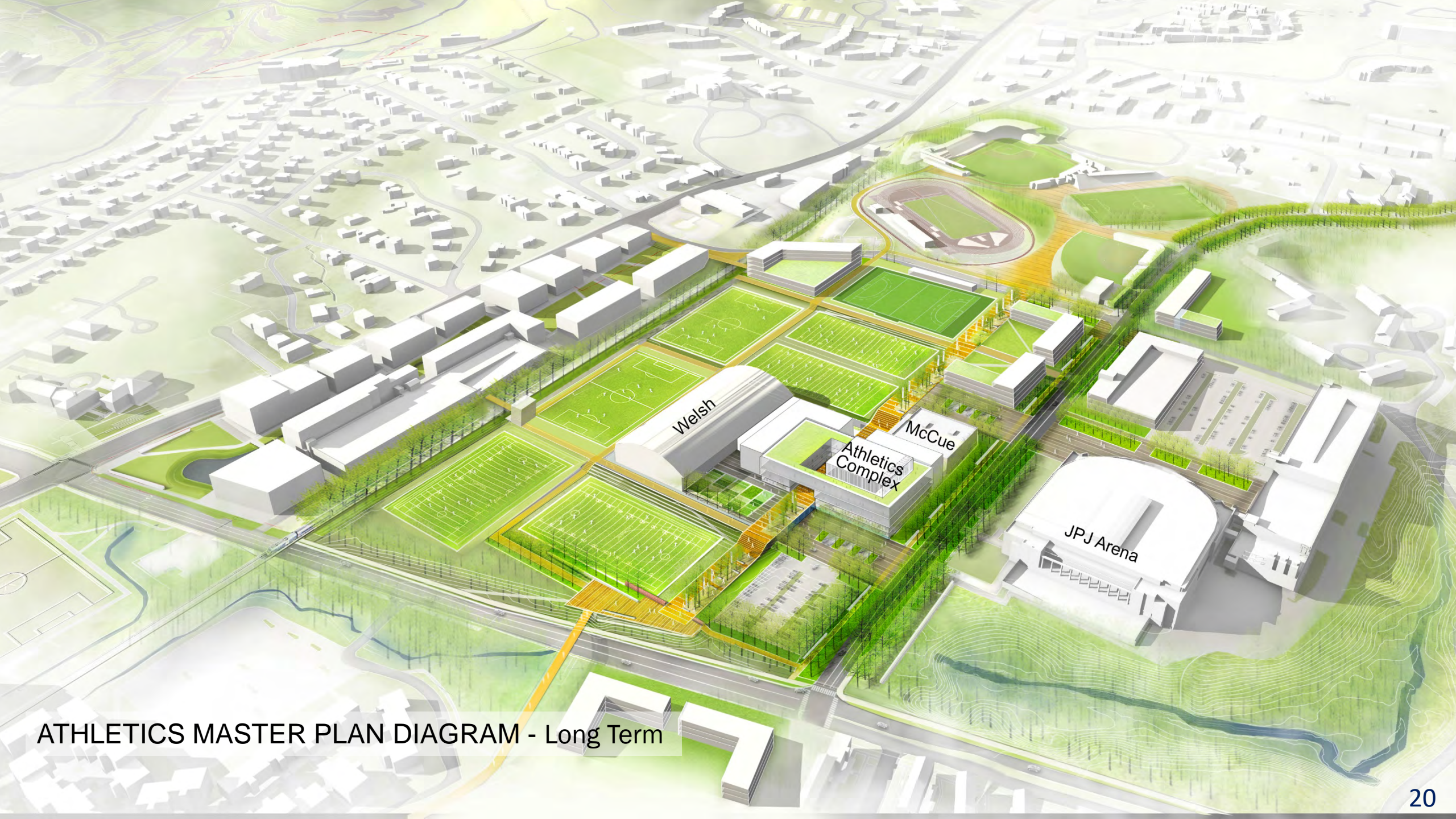

ATHLETICS MASTER PLAN DIAGRAM - Long Term

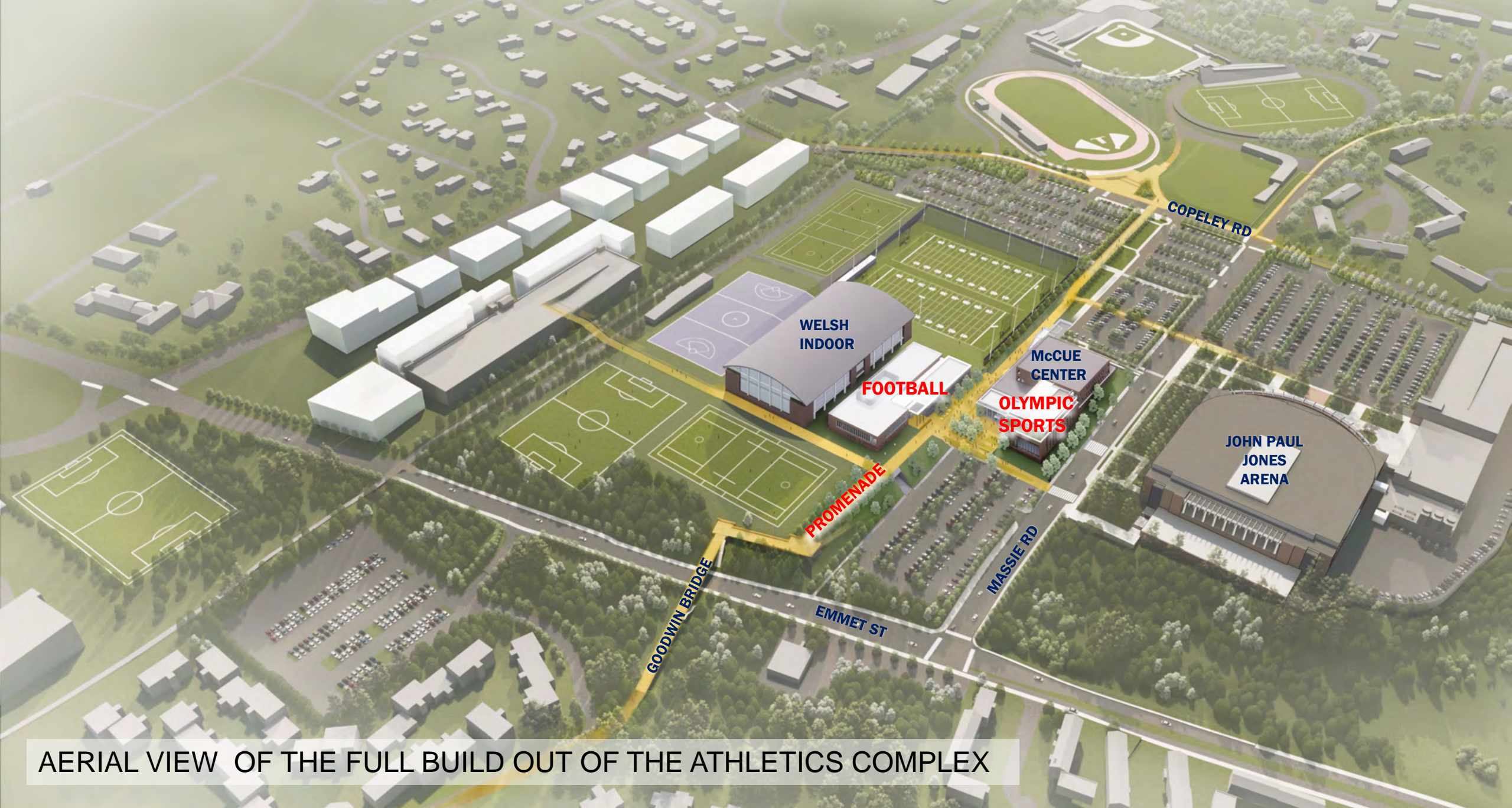

AERIAL VIEW OF THE FULL BUILD OUT OF THE ATHLETICS COMPLEX

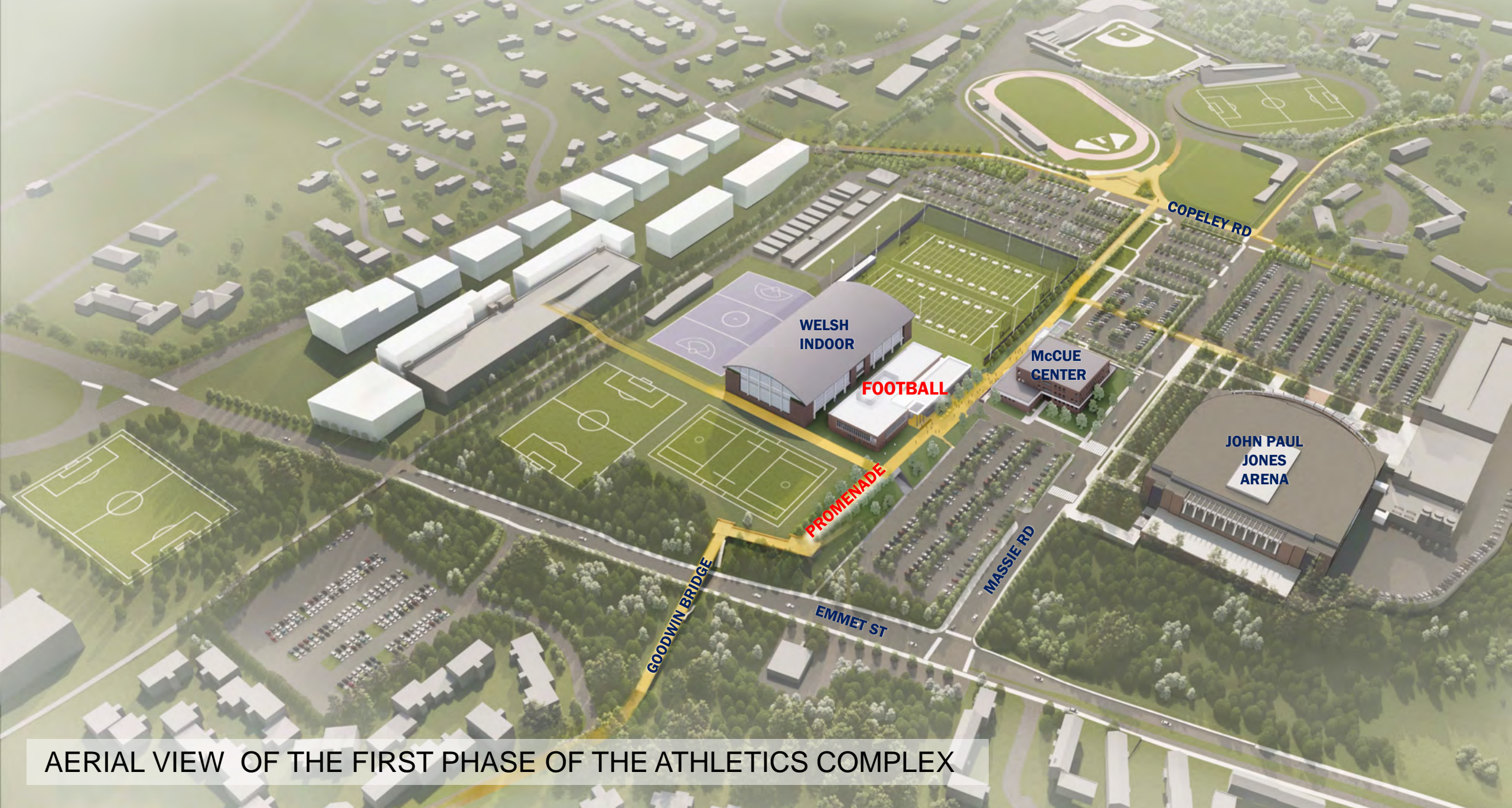

AERIAL VIEW OF THE FIRST PHASE OF THE ATHLETICS COMPLEX

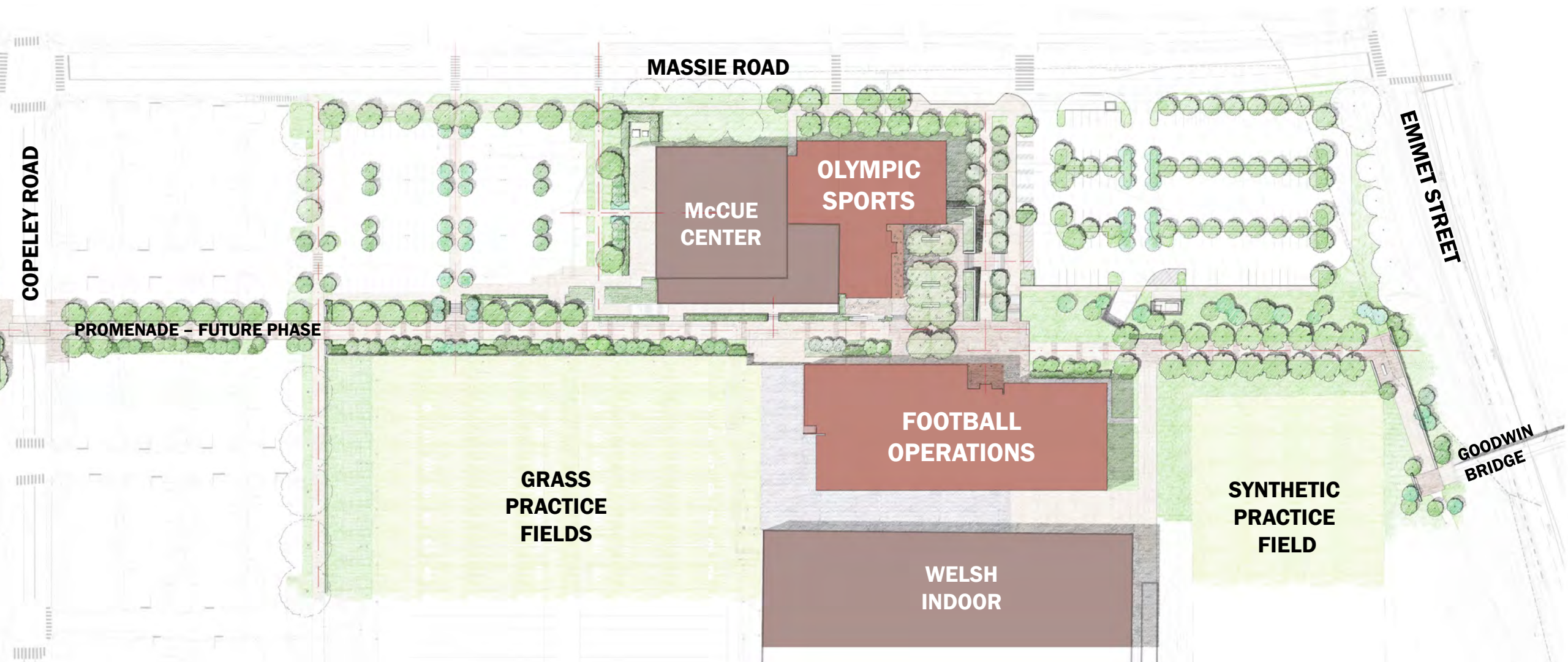

**SITE PLAN – FULL BUILD OUT WITH OLYMPIC SPORTS AND McCUE RENOVATION**

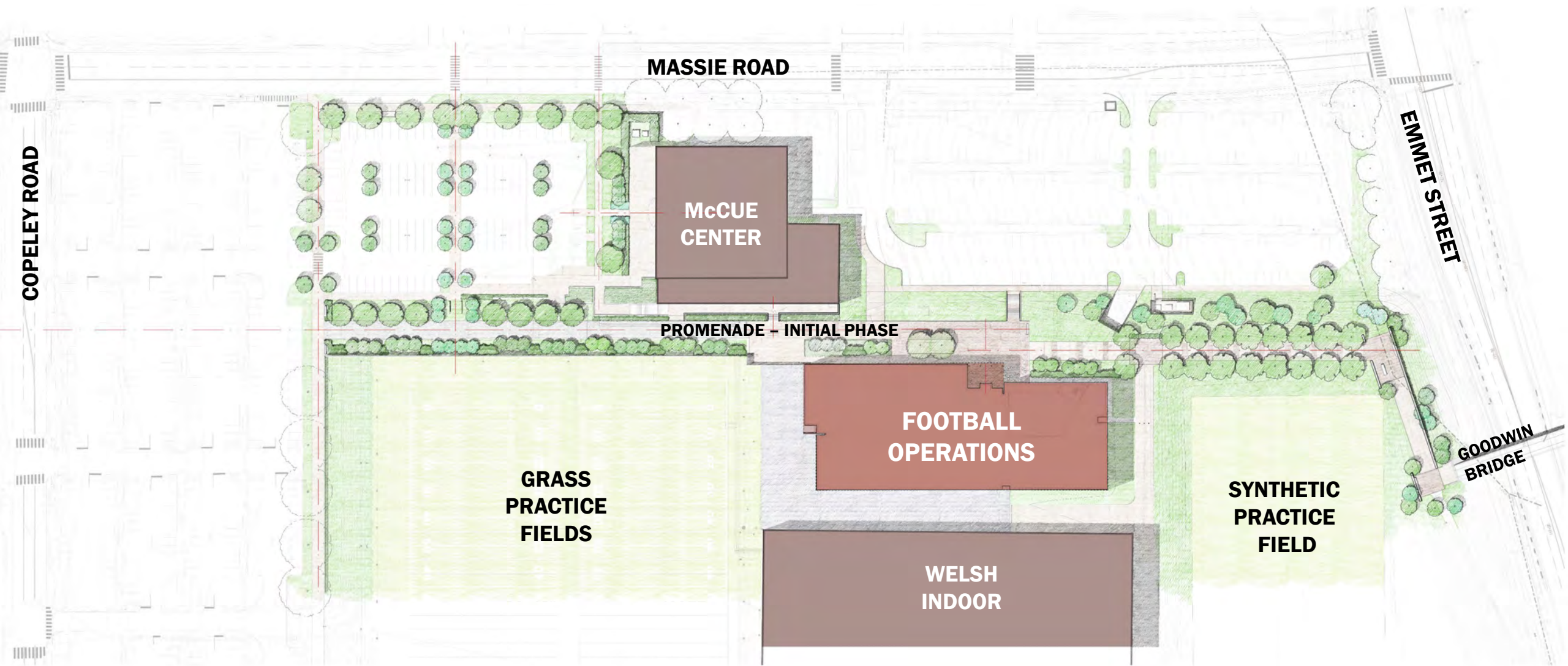

**SITE PLAN – FIRST PHASE OF FOOTBALL OPERATIONS**



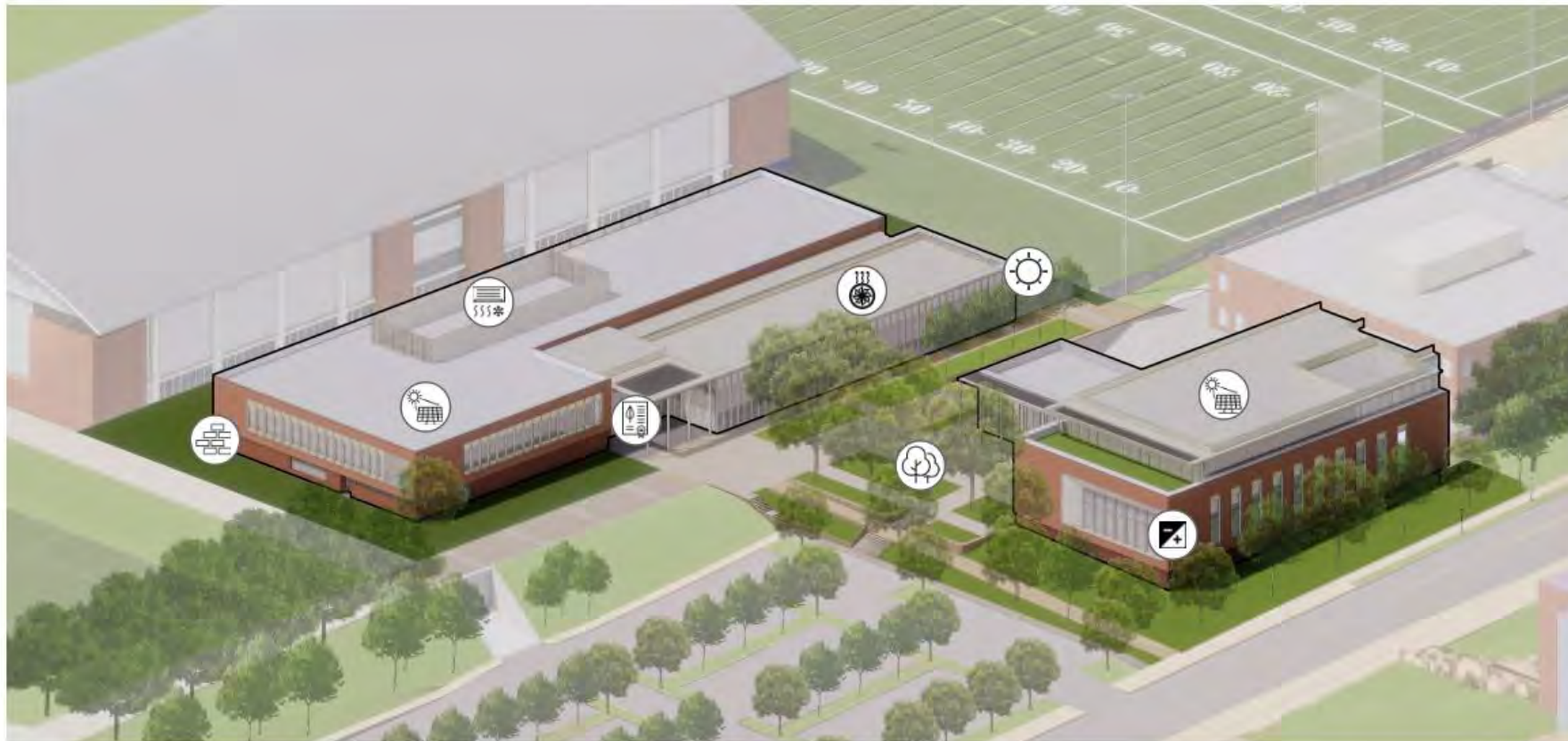

LEED v4 CERTIFIED DESIGN



LOW-VOC & TRANSPARENT PRODUCT INGREDIENT MATERIALS TO BE SELECTED FOR INTERIOR TO PROMOTE INDOOR AIR QUALITY



OPENINGS ORIENTED AND SIZED IN RESPONSE TO SOLAR RADIATION ANALYSIS TO LIMIT GLARE AND UNWANTED HEAT GAIN



EXTERIOR MATERIALS SELECTED FOR HIGH DURABILITY AND LIFE CYCLE COST PERFORMANCE



DISPLACEMENT VENTILATION HEATING/COOLING SYSTEM FOR STRENGTH & CONDITIONING ROOM



COMBINATION DOAS / SENSIBLE COOLING SYSTEM WITH ENERGY RECOVERY PROVIDES HIGH EFFICIENCY HVAC FOR BUILDING



NATURAL DAYLIGHT EMPHASIZED AND PROVIDED THROUGH LARGE GLAZED OPENINGS AND CLERESTORY WINDOWS



SHADED TREE CANOPIES AND LANDSCAPED OUTDOOR AREAS OF RESPIRE FOR STUDENT ATHLETES & STAFF



PV READY ROOF STRUCTURE



EXISTING VIEW FROM GOODWIN BRIDGE LOOKING WEST



PROPOSED VIEW FROM GOODWIN BRIDGE PLAZA LOOKING WEST



EXISTING VIEW FROM SYNTHETIC PRACTICE FIELD LOOKING WEST



PROPOSED VIEW FROM PROMENADE LOOKING WEST



EXISTING VIEW FROM MASSIE ROAD LOOKING SOUTHWEST



PROPOSED VIEW FROM MASSIE ROAD LOOKING SOUTHWEST



EXISTING VIEW FROM McCUE STAIR LOOKING SOUTHEAST





PROPOSED VIEW FROM McCUE STAIR LOOKING SOUTHEAST

# UVA Football Operations

## Material Palette



**Brick Precedent**



**Field Brick** Glen-Gary 'Cushwa Shendanoah'



**Articulated Base**



**Metal** 'Swiss Coffee' color tone

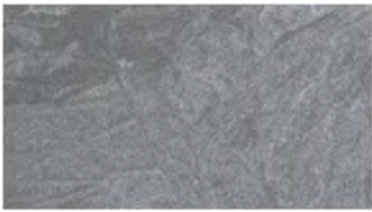

**Window Bases** Honed Granite



EXISTING VIEW FROM MASSIE ROAD LOOKING SOUTHEAST



PROPOSED VIEW FROM MASSIE ROAD LOOKING SOUTHEAST

